

# ASSEMBLY MANUAL

## OUTLET AND OVERFLOW SYSTEM FOR BATHTUB – PURUS

REV.	DATE	AUTHOR	COMMENTS
1.0	2012-09-24	K. Nowak	First official issue
2.0	2013-01-31	K. Nowak	Add two columns, deleted one column

NO	DESCRIPTION	Carat / Rosalie / Hampton		Egg / Rita / Ellipse		Modern Style / Vanja / Sand		Old Style / New England / Aurora		Marika		Carmel XL		Cyndrella XL		Carmel 1590		Tiffany 1690	
		PCS/L	PCS/L	PCS/L	PCS/L	PCS/L	PCS/L	PCS/L	PCS/L	PCS/L	PCS/L	PCS/L	PCS/L	PCS/L	PCS/L	PCS/L	PCS/L	PCS/L	PCS/L
1a	Click - clak	1																	
1b	Foam gasket Ø65x Ø47x4	1																	
2	Foam gasket Ø60x Ø50x3	1																	
3	Click-clak body	1																	
4	Connector set Ø32/ Ø32																		
4a	Plastic nut Ø32																		
4b	Rubber gasket Ø32																		
4c	Connector Ø32/ Ø32																		
4d	Rubber gasket Ø32																		
43	Plastic nut Ø32																		
5	Plastic pipe Ø32	8 cm	46 cm	8 cm	46 cm	8 cm	46 cm	8 cm	46 cm	8 cm	46 cm	8 cm	46 cm	8 cm	46 cm	8 cm	46 cm	8 cm	46 cm
6	Reduction Ø32/ Ø40	2	2	2	2	2	2	2	2	2	2	2	2	2	2	2	2	2	2
7	tee 45°/ Ø40	1	1	1	1	1	1	1	1	1	1	1	1	1	1	1	1	1	1
8	Odour lock	1	1	1	1	1	1	1	1	1	1	1	1	1	1	1	1	1	1
9	Odour lock body	1	1	1	1	1	1	1	1	1	1	1	1	1	1	1	1	1	1
10a	Plastic pipe Ø32	100 cm	100 cm	100 cm	100 cm	100 cm	100 cm	100 cm	100 cm	100 cm	100 cm	100 cm	100 cm	100 cm	100 cm	100 cm	100 cm	100 cm	100 cm
10b	Plastic pipe Ø32	17 cm	17 cm	17 cm	17 cm	17 cm	17 cm	17 cm	17 cm	17 cm	17 cm	17 cm	17 cm	17 cm	17 cm	17 cm	17 cm	17 cm	17 cm
11	Outlet elbow 45°/ Ø32	1	1	1	1	1	1	1	1	1	1	1	1	1	1	1	1	1	1
12	Overflow set																		
12a	Stainless steel screw 3.9x50																		
12b	Overflow cover																		
12c	Overflow ring																		
12d	Ring gasket																		
12e	Overflow tank																		
12f	Overflow tube Ø32																		
18a	Fixing clip	1	1	1	1	1	1	1	1	1	1	1	1	1	1	1	1	1	1
18b	Fixing clip	0	1	0	1	0	1	0	1	0	1	0	1	0	1	0	1	0	1
19a	Clip spacer	6	7	6	6	6	6	6	6	6	6	4	3	6	6	6	6	6	6
19b	Clip spacer	0	6	5	0	0	0	0	0	0	0	0	4	0	0	0	0	0	0
20a	Plastic pin	1	1	1	1	1	1	1	1	1	1	1	1	1	1	1	1	1	1
20b	Plastic pin	0	1	1	0	0	0	0	0	0	0	0	1	1	1	1	1	1	1
21a	Bolt M4 *C	1	1	1	1	1	1	1	1	1	1	1	1	1	1	1	1	1	1
21b	Bolt M4 *C	0	1	1	0	0	0	0	0	0	0	0	1	1	1	1	1	1	1

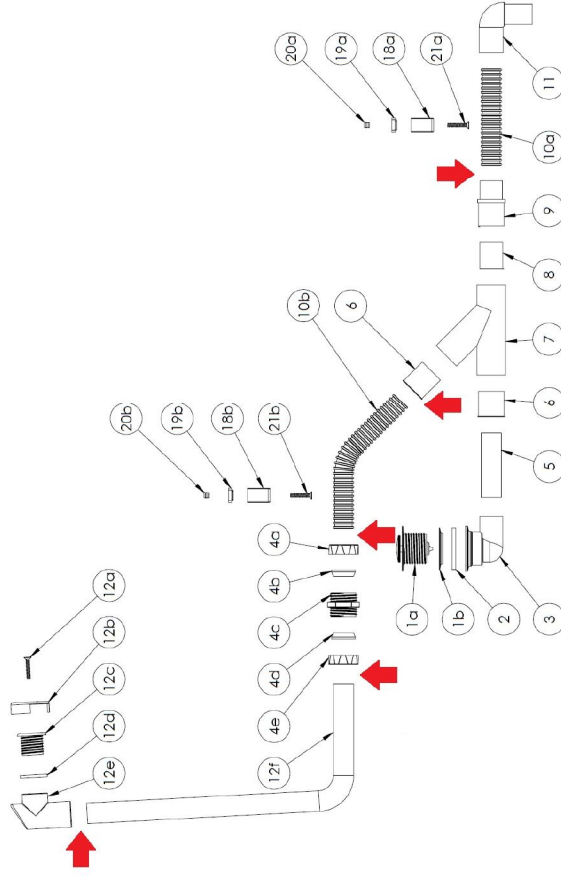

1. Drawing - diagram of outflow with odour lock

NO. OF SPACERS	LENGTH Bolts M4
3	30
4	35
5	40
6	45
7	50

2. Table - bolt length adjustment

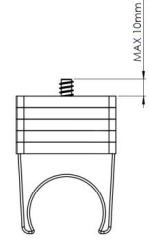

2. Drawing - example of a fixing clip

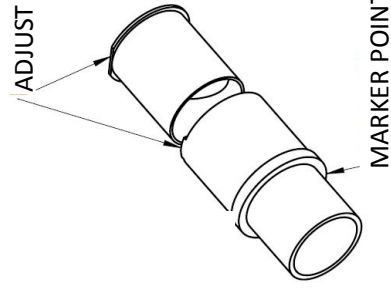

\*UWAGI

- Accurately align elements no. 8 and no. 9. See drawing no. 3.
- The marking on element no. 9 must be pointing down. See drawing no. 3.
- Select bolt length to the number of clip spacers according to table no. 2.