

DN	1/4"	3/8"	1/2"	3/4"	1"	1"1/4"	1"1/2"	2"	2"1/2"
L	76	76	82	90	106	120	142	165	194
L2	38	38	41	45	53	60	71	82.5	97
Ø	10	10	10	15	20	25	32	40	50
I	18	18	17	18.5	20	23.5	28.5	32	35
H	52	52	52	55.5	64	76.5	93.5	103.5	124
M	115	115	115	115	150	150	240	240	240
PN	40								

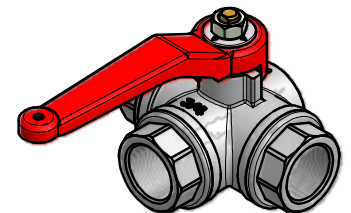

IN ACCORDING TO DIRECTIVE 97/23/CE TAB. 6

Ref.	Parts	Material	Q.ty
1	Body	EN12420-CW617N	1
2	Ball	EN12164-CW614N	1
3	Seat	P.T.F.E.	4
4	Pushrod	EN12164-CW614N	1
* 5	Gasket	P.T.F.E.	1
6	O-Ring	FPM (Viton)	1
7	Nut	UNI 7356-CB4FF	1
8	Nut	EN12164-CW614N	1
9	Sleeve	EN12420-CW617N	1
10	Lever	EN1011-DD13	1
11	Flux indicator	EN 7639 SGALSI 1	1
12	O-ring	FPM (Viton)	4

STANDARD VALVE FEATURES
 Working temperature : MIN. -10°C MAX. +100 °C
 Max pressure : 40 bar
 Threaded ends : ISO 228/1

SPECIAL EXECUTIONS ON REQUEST
 O-Ring in : FP/EPDM/SILICONE/HNBR Seats: PTFE + 25% CARBOGRAPYTE/
 Valve : CR brass material PTFE + 25%GLASS
 Personal lever

We don't assume the responsibility if you use products which are not consistent with the material used for the construction of our valves.
 To be used as a guide only, IDROSFER reserve the right to change these data without notice.

*: absent for measures 1"1/2 - 2" - 2"1/2 (seal with two O-rings)