

WATER METER CONNECTORS

TECHNICAL INFORMATION

Max. operating temperature: 180°C

Max. nominal pressure: 10 bar

Brass: CW614N (EN 12164) & CW617N (EN 12165)

Threads: EN ISO 228

FIBER INFORMATION

Uses for oils, fuels, air, water, steam (5 bars), and oxide and alkaline installations

Density 1.7 g/cm³ (according to DIN 3754)

Temperature test max 180 °C

Compression ASTM F36 10%

DIMENSIONS

ΣÉT Υδρομέτρου
Water Meter Connector

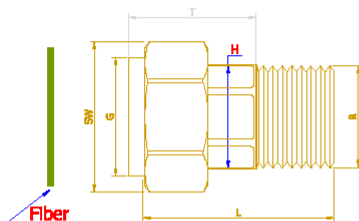

	L	T	SW	H	G	R
3/4"x1/2"	37	23	30	19	3/4"	1/2"
1"x3/4"	50	34	37	25	1"	3/4"
1 1/4"x1"	60	38	46	32	1 1/4"	1"
1 1/2"x1 1/4"	56	34	54	37	1 1/2"	1 1/4"
2"x 1 1/2"	67	45	68	44	2"	1 1/2"